

DEPARTMENT OF THE ARMY TECHNICAL MANUAL

OPERATOR'S
ORGANIZATIONAL, DIRECT SUPPORT, GENERAL
SUPPORT AND DEPOT MAINTENANCE REPAIR
PARTS AND SPECIAL TOOLS LIST
FOR
SEPARATOR, OIL AND WATER, SPRAY GUN,
WALL MTD (GRAY CO, INC,
MODELS 250-751 AND 250-432)
(4940-242-4100)

Headquarters, Department of the Army, Washington, D.C.

4 February 1970

This manual is current to 14 January 1970

	Page
Section	
I. INTRODUCTION	2
II. ORGANIZATIONAL REPAIR PARTS	5
III. DIRECT SUPPORT, GENERAL SUPPORT AND DEPOT REPAIR PARTS	8
IV. FEDERAL STOCK NUMBER AND REFERENCE NUMBER INDEX	11

*This manual supersedes TM 9-4940-461-20P, 29 September 1961, and SM ORD 7-8 SNL J-718 dated 12 February 1954.

Section I. INTRODUCTION

1. Scope

This manual lists basic issue items and repair parts required for the performance of operator, organizational, direct support, general support, and depot maintenance of the separator.

2. General

This Basic Issue Items, Repair Parts and Special Tools list is divided into the following sections:

- a. *Basic Issue Items*. Not applicable.
- b. *Maintenance and Operating Supplies*. Not applicable.
- c. *Prescribed Load Allowance (PLA)*. Not applicable.
- d. *Repair Parts- Section II*. A list of repair parts authorized for the performance of maintenance at the organizational level in figure and item number sequence.
- e. *Tools and Support Equipment*. Not applicable.
- f. *Repair Parts - Section III*. A list of repair parts authorized for the performance of maintenance at the direct support, general support, and depot level in figure and item number sequence.

g. *Special Tools, Test and Support Equipment*. Not applicable.

h. *Federal Stock Number and Reference Number Index . Section IV*. A list of Federal stock numbers in ascending numerical sequence, followed by a list of reference numbers appearing in all the listings, in ascending alpha-numeric sequence, cross-referenced to the illustration figure number and item number.

3. Explanation of Columns

The following provides an explanation of columns in tabular lists in Section II and III.

a. *Source, Maintenance, and Recoverability Codes (SMR)*.

(1) *Source code*. Indicates the selection status and source for the listed item. Source codes used are :

Code	Explanation
P	Applied to repair parts which are stocked in or supplied from GSA/DSA, or Army supply system and authorized for use at indicated maintenance categories.
M	Applied to repair parts which are not procured or stocked but are to be manufactured at indicated maintenance categories.
A	Applied to assemblies which are not procured or stocked as such but are made up of two or more units, each of which can-y individual

Code	Explanation
X	stock numbers and descriptions and are procured and stocked and can be assembled by units at indicated maintenance categories. Applied to parts and assemblies which are not procured or stocked; the mortality of which normally is below that of the applicable end item; and the failure of which should result in retirement of the end item from the supply system.
X1	Applied to repair parts which are not procured or stocked, the requirement for which will be supplied by use of next higher assembly or component.
X2	Applied to repair parts which are not stocked. The indicated maintenance category requiring such repair parts will attempt to obtain through cannibalization, if not obtainable through cannibalization, such repair parts will be requisitioned with supporting justification through normal supply channels.
G	Applied to major assemblies that are procured with PEMA funds for initial issue only to be used as exchange assemblies at DSU and GSU level. These assemblies will not be stocked above DSU and GSU level or returned to depot supply level.

(2) *Maintenance code*. Indicates the lowest category of maintenance authorized to install the listed item. Maintenance level codes are:

Code	Explanation
C	Operator/Crew maintenance
O	Organizational maintenance
F	Direct support maintenance
H	General support maintenance
D	Depot maintenance

(3) *Recoverability code*. Indicates whether unserviceable items should be returned for recovery or salvage. Items not coded are expendable. Recoverability codes are:

Code	Explanation
R	Applied to repair parts (assemblies and components) which are considered economically repairable at direct and general support maintenance levels. When the maintenance capability to repair these items does not exist, they are normally disposed of at the GS level. When supply considerations dictate, some of these repair parts maybe listed for automatic return to supply for depot level repair as set forth in AR 710-50. When so listed, they will be replaced by supply on an exchange basis.
T	Applied to high dollar value recoverable repair parts which are subject to special handling and

Code

Explanation

- are issued on an exchange basis. Such repair parts normally are repaired or overhauled at depot maintenance activities.
- U Applied to repair parts specifically selected for salvage by reclamation units because of precious metal content, critical materials, or high dollar value reusable casings or castings.

NOTE: When no code is indicated in the recoverability column, the part will be considered expendable.

b. Federal Stock Number. Indicates the Federal stock number assigned to the item and will be used for requisitioning purposes.

c. Description. Indicates the Federal item name and any additional description required. A part number or other reference number is followed by the applicable five-digit Federal supply code for manufacturers in parentheses.

d. Unit of Measure (U/M). A two character alphabetic abbreviation indicating the amount or quantity of the item upon which the allowances are based, e.g., EA, PR, etc.

e. Quantity Incorporated in Unit. Indicates the quantity of the item used in the assembly group.

f. 15-Day Organizational Maintenance Allowance.

(1) The allowance columns are divided into four subcolumns. Indicated in each subcolumn opposite the first appearance of each item is the total quantity of items authorized for the number of equipments supported. Subsequent appearances of the same item will have the letters "REF" in the allowance columns. Items authorized for use as required but not for initial stockage are identified with an asterisk in the allowance column.

(2) The quantitative allowances for organizational level of maintenance represents one initial prescribed load for a 15-day period for the number of equipments supported. Units and Organizations authorized additional prescribed loads will multiply the number of prescribed loads authorized by the quantity of repair parts reflected in the appropriate density column to obtain the total quantity of repair parts authorized.

(3) Organizational units providing maintenance for more than 100 of these equipments shall determine the total quantity of parts required by converting the equipment quantity to a decimal factor by placing a decimal point before the next to last digit of the number to indicate hundredths, and multiplying the decimal factor by the parts quantity authorized in the 51-100 allowance column. Example, authorized allowance for 51-100 equipments is 12; for 140 equipments multiply 12 by 1.40 or 16.80 rounded off to 17 parts required.

(4) Subsequent changes to allowances will be limited as follows: No change in the range of items is authorized. If additional items are considered necessary, recommendation should be forwarded to Commanding General, U.S. Army Weapons Command, Rock Island, Illinois 61201, for exception or revision to the allowance list. Revisions to the range of items authorized will be based upon engineering experience, demand data, or The Army Equipment Record System (TAERS) information.

g. 30-Day DS/GS Maintenance Allowances.

NOTE: Allowances in GS Column are for GS maintenance only.

(1) The allowance columns are divided into three subcolumns. Indicated in each subcolumn, opposite the first appearance of each item, is the total quantity of items authorized for the number of equipments supported. Subsequent appearances of the same item will have the letters "REF" in the applicable allowance columns. Items authorized for use as required but not for initial stockage are identified with an asterisk in the allowance column.

(2) **The quantitative allowances for DS/GS** levels of maintenance will represent initial stockage for a 30 day period for the number of equipments supported.

(3) Determination of the total quantity of parts required for maintenance of more than 100 of these equipments can be accomplished by converting the equipment quantity to a decimal factor by placing a decimal point before the next to last digit of the number to indicate hundredths, and multiplying the decimal factor by the parts quantity authorized allowances for 51-100 allowance column. Example, authorized allowance for 51-100 is 40; for 150 equipments multiply 40 by 1.50 or 60 parts required.

h. 1-Year Allowance Per 100 Equipments ./Contingency Planning Purposes. This column indicates opposite the first appearance of each item the total quantity required for distribution and contingency planning purposes. The range of items indicate total quantities of all authorized items required to provide for adequate support of 100 equipments for one year.

i. Depot Maintenance Allowance per 100 Equipments. This column indicates opposite the first appearance of each item, the total quantity authorized for depot maintenance of 100 equipments. Subsequent appearances of the same item will have the letters "REF" in the allowance column. Items authorized for use as required but not for initial stockage are identified with an asterisk in the allowance column.

j. Illustration.

(1) *Figure number.* Indicates the figure

SECTION II. REPAIR PARTS LIST-ORGANIZATIONAL MAINTENANCE

(1) SOURCE MAINT. AND RECOV. CODE			(2) FEDERAL STOCK NO.	(3) DESCRIPTION REFERENCE NO. AND MFR. CODE	(4) QTY. INC. IN UNIT PACK	(5) QTY. INC. IN UNIT	(6) 15 DAY ORGANIZATIONAL MAINT. ALLOWANCE				(7) ILLUSTRATION	
(A) SOURCE	(B) MAINT	(C) RECOV.					(A) 1-5	(B) 6-20	(C) 21-50	(D) 51-100	(A) FIGURE NO.	(B) ITEM NO.
P	O		5330-054-6929	PACKING, PREFORMED SYN-RU, 1/2 ID, 11/16 OD, 3/32 H O/A 158-032 (25980)	EA	1	*	2	4	6	1	5
P	O		4940-733-2421	GASKET, SEPARATOR HEAD 159-501 (25980)	EA	1	*	4	4	8	1	7
P	O		4940-733-2414	PARTS KIT, OIL AND WATER SEPARATOR AIR REGULATOR ASSY 205-618 (25980) C/O ONE OF EACH OF THE FOLLOWING:	EA	1	2	2	4	4	1	14
P	O		5330-691-8165	GASKET, RUBBER 160-170 (25980)							1	14A
P	O		4930-378-4110	SEAT, REGULATOR VALVE 157-798 (25980)							1	14B
P	O		5340-682-5831	GASKET, COPPER 152-224 (25980)							1	14C
P	O		4930-691-8149	VALVE, REGULATOR 157-800 (25980)							1	14D
P	O		5340-378-4172	SPRING, COMPRESSION 156-200 (25980)							1	14E
P	O		4930-712-9343	SPRING, VALVE FRICTION 158-188 (25980)							1	14F
P	O		4930-691-8176	DIAPHRAGM ASSY 203-752 (25980)							1	14G
P	O		5340-691-8141	WASHER, DIAPHRAGM S, ZN-PLTD, 1.906 ID 2.187 OD, 0.0359 THK 156-196 (25980)							1	14H
P	O		4820-422-5049	COCK, PLUG BR, 1/4NPT MALE ONE END, 1/4NPSH MALE OTHER END, 100 PSI WP, AIR FHS7 (17431)	EA	2	*	2	4	4	1	15
P	O		4940-061-7096	FILTER, SPRAY UNIT BZ, POROUS 157-808 (25980)	EA	1	*	2	2	4	1	19

SECTION II. REPAIR PARTS LIST-ORGANIZATIONAL MAINTENANCE

(1) SOURCE MAINT. AND RECOV. CODE	(2) FEDERAL STOCK NO.	(3) DESCRIPTION REFERENCE NO. AND MFR CODE	(4) UNIT OF ISSUE	(5) QTY. INC. IN. UNIT PACK	(6) 15 DAY ORGANIZATIONAL MAINT. ALLOWANCE				(7) ILLUSTRATION	
(A) SOURCE	(B) MAINT.	(C) RECOV.			(A) 1-5	(B) 6-20	(C) 21-50	(D) 51-100	(A) FIGURE NO.	(B) ITEM NO.
P	O	6685-239-5697	EA	1	*	*	2	2	1	20
GAGE, PRESSURE, DIAL INDICATING SGLE BOURBON TU TYPE BZ ACTUATING ELEMENT, 0 TO 200 PSI SGLE- READING PRESSURE SCALE W/40 LB FIG. INTERVALS, 5 LB SMALLEST GRAD DIV, BLACK FIG. ON WHITE BACKGROUND, 2 1/2 DIA DIAL. NONADJ POINT- ER, 2-23/32 DIA X 1-3/16 DEEP S CASE, SGLE 1/4 NPT BOTTOM MALE CONNECTION, RIGID STEM MTG 500S (61349)										
P	O	6685-424-5726	EA	1	*	*	2	2	1	21
GAGE, PRESSURE, DIAL IN- DICATING SGLE BOURDON BZ MULTIPLE READING, 0 TO 100 PSI SCALE, 10 LB FIG. IN- Tervals, 10 LB SMALLEST GRAD DIV, BLACK FIG. ON WHITE BACKGROUND, 0 TO 7 KG PER GM, 1 KG FIG. IN- Terval, 1/2 KG SMALLEST GRAD DIV, BLACK FIG. ON WHITE BACKGROUND, 2 DIA DIAL, BLACK POINTER, NONADJUSTABLE, S CASE, ENMLD, 2 DIA, 7/8 DEEP, 1/4 NPT SGLE EXTER CONNECTION, RIGID STEM MTG GA-100 (17431)										

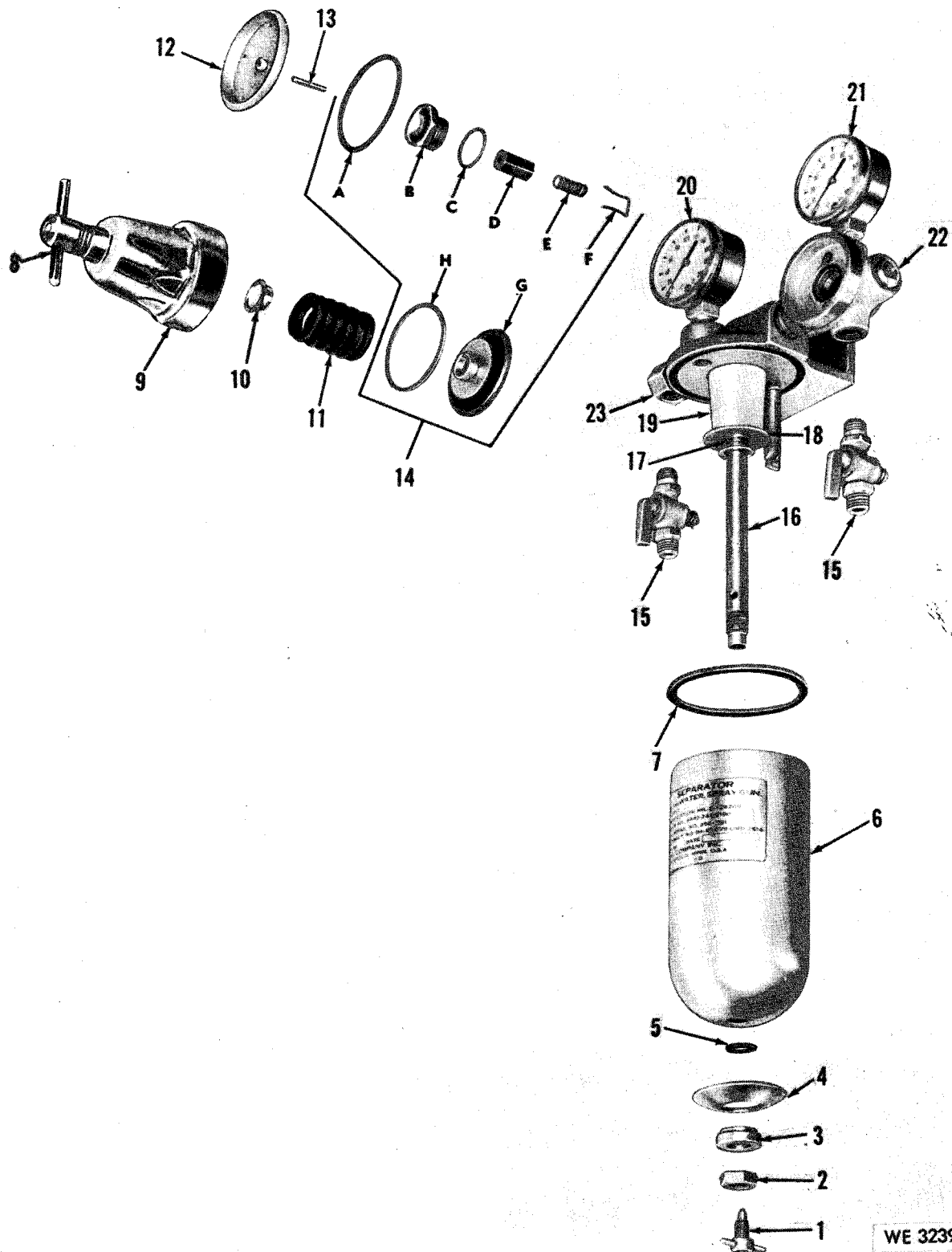

WE 32399B

Figure 1. Separator - exploded view

SECTION III. DIRECT SUPPORT, GENERAL SUPPORT AND DEPOT MAINTENANCE REPAIR PARTS LIST

ACT ON CODE	(1) SOURCE MAINT. AND RECOV. CODE			(2) FEDERAL STOCK NO.	(3) DESCRIPTION REFERENCE NO. AND MFR. CODE USABLE ON CODE REPAIR PARTS	(4) UNIT OF MEAS	(5) QTY. INC. IN UNIT	(6) 30-DAY DS MAINT ALLOWANCE			(7) 30-DAY GS MAINT ALLOWANCE			(8) 1-YR ALW PER 100 EQUIP CNTGCTY	(9) DEPOT MAINT ALW PER 100 EQUIP	(10) ILLUSTRATION	
	(A)	(B)	(C)					(A)	(B)	(C)	(A)	(B)					
	SOURCE	MAINT	RECOV					1-20	21-50	51-100	1-20	21-50	51-100			FIG NO.	ITEM NO.
P	F			4940-245-1223	STEM, NEEDLE VALVE 203-499 (25980)	EA	1	*	*	*	*	*	*	2	2	1	1
P	F			5310-834-8734	NUT,HEX,PLAIN S, CD-PLTD, 1/2-20UNF, 5/16 W	EA	1	*	*	*	*	*	*	*	*	1	2
P	F			5330-410-6500	RETAINER,PACKING 161-433 (25980)	EA	1	*	*	*	*	*	*	*	*	1	3
P	F			4940-245-1219	CAP,REINFORCING 161-432 (25980)	EA	1	*	*	*	*	*	*	*	*	1	4
P	O			5330-054-6929	PACKING, PREFORMED SYN-RU, 1/2 ID, 11/16 OD, 3/32 H O/A 158-032 (25980)	EA	1	*	2	2	*	*	2	4	4	1	5
P	F			4940-245-1216	BOWL, SEDIMENT SEPARATOR 159-407 (25980)	EA	1	*	*	*	*	*	*	*	*	1	6
P	O			4940-733-2421	GASKET,SEPARATOR HEAD 159-501 (25980)	EA	1	*	2	2	*	4	4	6	6	1	7
P	F			4940-245-1314	SCREW AND HANDLE ASSEMBLY: 206-055 (25980)	EA	1	*	*	*	*	*	*	*	*	1	8
P	F			4940-245-1313	CAP,REGULATOR 165-341 (25980)	EA	1	*	*	*	*	*	*	*	*	1	9
P	F			4940-245-1221	SEAT, HELICAL COMPRESSION SPRING 164-335 (25980)	EA	1	*	*	*	*	*	*	*	*	1	10
P	F			5360-403-7781	SPRING, COMPRESSION 161-618 (25980)	EA	1	*	*	*	*	*	*	*	*	1	11
P	F			4940-245-1222	PLATE,BAFFLE: AIR REGULATOR 161-616 (25980)	EA	1	*	*	*	*	*	*	*	*	1	12
P	F			5315-410-4881	PIN, STRAIGHT, HEADLESS AIR REGULATOR 161-615 (25980)	EA	1	*	*	*	*	*	*	*	*	1	13
P	O			4940-733-2414	PARTS KIT, OIL AND WATER SEPARATOR AND AIR REGULATOR ASSY 205-618 (25980)	EA	1	2	2	4	2	4	6	8	8	1	14

SECTION III. DIRECT SUPPORT, GENERAL SUPPORT AND DEPOT MAINTENANCE REPAIR PARTS LIST

ACT ON CODE	(1) SOURCE MAINT. AND RECOV. CODE			(2) FEDERAL STOCK NO.	(3) DESCRIPTION REFERENCE NO. AND MFR. CODE	(4) UNIT OF MEAS.	(5) QTY. INC. IN UNIT	(6) 30-DAY DS MAINT ALLOWANCE			(7) 30-DAY GS MAINT ALLOWANCE			(8) 1-YR ALW PER 100 EQUIP CNTGCV	(9) DEPOT MAINT ALW PER 100 EQUIP	(10) ILLUSTRATION	
	(A)	(B)	(C)					(A)	(B)	(C)	(A)	(B)	(A)			(B)	
	20-Jan	21-50	51-100					20-Jan	21-50	51-100	FIG. NO.	ITEM NO.					
					USABLE ON CODE REPAIR PARTS LIST-CONTINUED C/O ONE OF EACH OF THE FOLLOWING:												
P	O			5330-691-8165	GASKET, RUBBER 160-170 (25980)											1	14A
P	O			4930-378-4110	SEAT,REGULATOR VALVE 157-798 (25980)											1	14B
P	O			5340-682-5831	GASKET,COPPER 152-224 (25980)											1	14C
P	O			4930-691-8149	VALVE,REGULATOR 157-800 (25980)											1	14D
P	O			5340-378-4172	SPRING,COMPRESSION 156-200 (25980)											1	14E
P	O			4930-712-9343	SPRING, VALVE, FRICTION 158-188 (25980)											1	14F
P	O			4930-691-8176	DIAPHRAGM ASSEMBLY 203-752 (25980)											1	14G
P	O			5340-691-8141	WASHER, DIAPHRAGM BACKUP S, ZN-PLTD, 1.906 ID, 2.187 OD, 0.0359 THK 156-196 (25980)											1	14H
P	O			4820-422-5049	COCK,PLUG BR, 1/4 NPT MALE ONE END, 1/4 NPSH MALE OTHER END, 100 PSI WP, AIR PH87 (17431)	EA	2	*	*	4	*	*	4	4	6	1	15
P	F			4940-245-1218	ROD,TIE AIR REGULATOR 161-617 (25980)	EA	1	*	*	*	*	*	*	*	*	1	16
P	F			5360-403-7780	SPRING,COMPRESSION 151-221 (25980)	EA	1	*	*	*	*	*	*	*	*	1	17
P	F			4940-245-1215	RETAINER,FILTER 159-408 (25980)	EA	1	*	*	*	*	*	*	*	*	1	18
P	O			4940-061-7096	FILTER,SPRAY UNIT BZ POROUS 157-808 (25980)	EA	1	*	*	*	*	*	*	*	*	1	19
P	O			6685-239-5697	GAGE, PRESSURE, DIAL IN- DICATING SGLE BOURDON TU TYPE BZ ACTUATING ELEMENT, 0 TO 200 PSI SGLE- READING PRESSURE SCALE W/40 LB.FIG.INTERVALS. 5 LB	EA	1	*	*	*	*	*	*	*	*	1	20

SECTION III. DIRECT SUPPORT, GENERAL SUPPORT AND DEPOT MAINTENANCE REPAIR PARTS LIST-CONTINUED

ACT ON CODE	(1) SOURCE MAINT AND RECOV CODE			(2) FEDERAL STOCK NO.	(3) DESCRIPTION REFERENCE NUMBER & MFR CODE USABLE ON CODE	(4) UNIT OF MEAS	(5) QTY INC IN UNIT	(6) 30-DAY DS MAINT ALLOWANCE			(7) 30-DAY GS MAINT ALLOWANCE			(8) 1-YR ALW PER 100 EQUIP CNTGCV	(9) DEPOT MAINT ALW PER 100 EQUIP	(10) ILLUSTRATION	
	(A)	(B)	(C)					(A)	(B)	(C)	(A)	(B)	(A)			(B)	
					REPAIR PARTS LIST-CONTINUED			(A)	(B)	(C)	(A)	(B)	(C)			(A)	(B)
					SMALLEST GRAD DIV, BLACK FIG. ON WHITE BACKGROUND 2-1/2 DIA DIAL, NONADJ POIN- TER, 2-23/32 DIA X 1-3/16 DEEP S CASE, SGLE 1/4 NPT BOTTOM MALE CONNECTION, RIGID STEM MTG 500S (61349)			1-20	21-50	51-100	1-20	21-50	51-100			FIG NO.	ITEM NO.
P	O			6685-424-5726	GAGE, PRESSURE, DIAL IN- DICATING SGLE BOURDON BZ, MULTIPLE READING, 0 TO 100 PSI SCALE, 10 LB FIG. IN- TERVALS, 10 LB SMALLEST GRAD DIV, BLACK FIG ON WHITE BACKGROUND, 0 TO 7 KG PER GM 1 KG FIG. INTERVAL, 1/2 KG SMALLEST GRAD DIV, BLACK FIG. ON WHITE BACKGROUND, 2 DIA DIAL, BLACK POINTER, NONAD- JUSTABLE, S CASE, ENMLD, 2 DIA, 7/8 DEEP, 1/4 NPT SGLE EXTER CONNECTION, RIGID STEM MTG GA-100 (17431)	EA	1	*	*	*	*	*	*	*	1	21	
P	F			4940-245-1220	BODY,REGULATOR	EA	1	*	*	*	*	*	*	*		1	22
P	F			4940-245-1217	161-613 (25980) HEAD,SEPARATOR	EA	1	*	*	*	*	*	*	*		1	23
P	F			4730-595-3108	W 1/2 NPT AIR INLET 159-544 (25980) NIPPLE,PIPE	EA	1	*	*	*	*	*	*	*			
P	F			4730-011-5711	BR, 1/2 NPTF THD 5/16 HEX, 1-13/16 LG O/A PLUG,PIPE BR, 3/8 NPT/M THD, SOLID BODY	EA	1	*	*	*	*	*	*	*			

SECTION IV. INDEX-FEDERAL STOCK NUMBER AND REFERENCE NUMBER CROSS-
 REFERENCE TO FIGURE TO ITEM NUMBER

STOCK NUMBER	FIGURE NO.	ITEM NO.	REFERENCE NO.	MFG CODE	FIG NO.	ITEM NO.
4730-011-5711			GA-100	17431	1	21
4730-595-3108			PH87	17431	1	15
4820-422-5049	1	15	151-221	25980	1	17
4930-378-4110	1	14B	152-224	25980	1	14C
4930-691-8149	1	14D	156-196	25980	1	14H
4930-691-8176	1	14G	156-200	25980	1	14E
4930-712-9343	1	14F	157-798	25980	1	14B
4940-061-7096	1	19	157-800	25980	1	14D
4940-245-1215	1	18	157-808	25980	1	19
4940-245-1216	1	6	158-032	25980	1	5
4940-245-1217	1	23	158-188	25980	1	14F
4940-245-1218	1	16	159-407	25980	1	6
4940-245-1219	1	4	159-408	25980	1	18
4940-245-1220	1	22	159-501	25980	1	7
4940-245-1221	1	10	159-544	25980	1	23
4940-245-1222	1	12	160-170	25980	1	14A
4940-245-1223	1	1	161-432	25980	1	4
4940-245-1313	1	9	161-433	25980	1	3
4940-245-1314	1	8	161-613	1	22	
4940-733-2414	1	14	161-615	25980	1	13
4940-733-2421	1	7	161-616	25980	1	12
5310-834-8734	1	2	161-617	25980	1	16
4213-410-4881	1	13	161-618	25980	1	11
5330-054-6929	1	5	164-335	25980	1	10
5330-410-6500	1	3	165-341	25980	1	9
5330-691-8165	1	14A	203-499	25980	1	1
5340-378-4172	1	14E	203-752	25980	1	14G
5340-682-5831	1	14C	205-618	25980	1	14
5340-691-8141	1	14H	206-055	25980	1	8
5360-403-7780	1	17	500S	61349	1	20
5360-403-7781	1	11				
6685-239-5697	1	20				
6685-424-5726	1	21				

By Order of the Secretary of the Army:

W. C. WESTMORELAND,
*General, United States Army,
Chief of Staff.*

Official:

KENNETH G. WICKHAM
*Major General, United States Army,
The Adjutant General.*

DISTRIBUTION :

Active Army:

DCSLOG (1)	Engr FLDMS (2)
CNGB (1)	PF (1)
CofEngrs (2)	Corps (1)
CofSpts (1)	USACOMZEUR (2)
ACSC-E (1)	USAAVSCOM (2)
TSG (1)	USAOC&S (3)
Dir of Trans (3)	USASCS (1)
USCONARC (3)	USMA (2)
ARADCOM (2)	USAADS (1)
ARADCOM Rgn (2)	USAARMC (1)
OS Maj Cored (2)	WSMR (2)
OS Base Cored (2)	USATSCH (2)
LOGCOMD (1)	USAES (1)
USAWECOM (75)	Hqs U.S. Army Sig Con (1)
Armies (3)	Units org under fol TOE:
Ft Knox FLDMS (10)	(2 cys ea unit)
USACDCEC (10)	8-510
TC FLDMS (2)	8-563
Army Dep (3)	8-564
Arsenals (3)	

NG: State AG (3)

USAR: None

For explanation of abbreviations used, see AR 310-50.